

# CONSEW MODEL 310

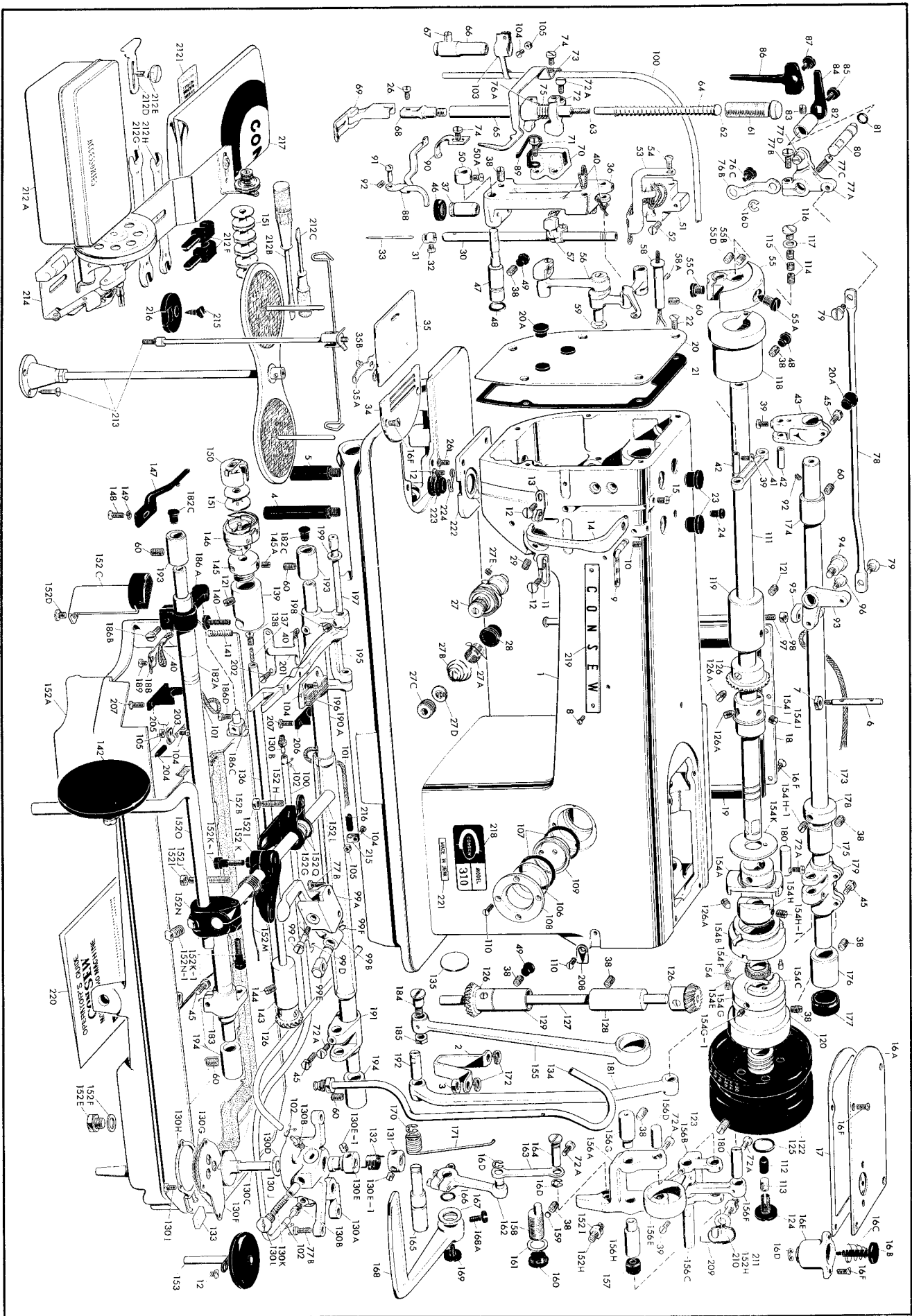

# CONSEW MODEL 310

PART NO.	PART NAME	PART NO.	PART NAME	PART NO.	PART NAME	PART NO.	PART NAME
1	2129001-100-C ARM BED ASSEMBLY	64	2129003-214 PRESSER SPRING, OUTER	125	9060100-006 PACKING FOR 122	156F	2129405-171 LINK FOR 179
2	2110901-151-B BELT LEG, RIGHT	65	2110903-211 PRESSER BAR ONLY	126	2110204-012 GEAR COMPLETE	156G	2129405-217 SHAFT, LEFT FOR 156A
3	2129001-119 NUT FOR 2	66	2129003-215 PRESSER BAR BUSHING	127	2129004-241 VERTICAL SHAFT ONLY	156H	2129405-318 SHAFT, RIGHT FOR 156A
4	2129001-153-A BEL LEG, FRONT	67	9501001-215 SET SCREW FOR 66	128	2110904-241 VERTICAL SHAFT UPPER	157	2129405-324 SOFT PLUG FOR 156A
5	2110212-311 SPOOL, PIN	68	2129003-219 HINGED FOOT	129	2110204-242 VERTICAL SHAFT LOWER	158	9542920-107 OIL STOP SCREW FOR 158
6	2110902-319 NUT FOR 6	69	2129003-238-A PRESSER BAR FOR 70	130	2129005-100-B BEL HING	159	2110203-216-B PACKING FOR 160
7	9540805-102 SET SCREW FOR NAME PLATE	70	2129003-239 PRESSER BAR FOR 72	131	2129005-100-B BEL HING COMPLETE	160	2129405-344 FEED REGULATOR ARM
8	2110292-312-C THREAD GUIDE WITH THREE HOLES	71	2110292-239 PRESSER BAR FOR 72	132	2129005-101-B BEL HING COMPLETE	161	2129405-344 FEED REGULATOR ARM
9	9501101-259 SET SCREW FOR 9	72	2110292-239 PRESSER BAR FOR 72	133	2129005-101-B BEL HING COMPLETE	162	2129405-344 FEED REGULATOR ARM
10	2110902-313-A THREAD GUIDE, RIGHT	73	9501102-235 SET SCREW FOR 72, 180, ETC	134	2129005-101-B BEL HING COMPLETE	163	2129405-344 FEED REGULATOR ARM
11	9540906-119 SET SCREW FOR 11, 13, ETC	74	9541004-216-A SPRING FOR 72 & 90	135	2129005-101-B BEL HING COMPLETE	164	2129405-344 FEED REGULATOR ARM
12	2129402-315-B THREAD GUIDE, LEFT	75	2110292-216-A SPRING FOR 72	136	2129005-101-B BEL HING COMPLETE	165	2129405-344 FEED REGULATOR ARM
13	2129402-315-B THREAD GUIDE, LEFT	76	2110292-216-A SPRING FOR 72	137	2129005-101-B BEL HING COMPLETE	166	2129405-344 FEED REGULATOR ARM
14	2129402-315-B THREAD GUIDE, LEFT	77	2110292-216-A SPRING FOR 72	138	2129005-101-B BEL HING COMPLETE	167	2129405-344 FEED REGULATOR ARM
15	9541004-221 GUARD FOR TAKE UP LEVER	78	2110292-216-A SPRING FOR 72	139	2129005-101-B BEL HING COMPLETE	168	2129405-344 FEED REGULATOR ARM
16	2129401-210-B ARM COVER PLATE COMPLETE	79	2110292-216-A SPRING FOR 72	140	2129005-101-B BEL HING COMPLETE	169	2129405-344 FEED REGULATOR ARM
16A	2129401-211 ARM COVER PLATE	80	2110292-216-A SPRING FOR 72	141	2129005-101-B BEL HING COMPLETE	170	2129405-344 FEED REGULATOR ARM
16B	2129401-221-A PUSH BUTTON	81	9060100-011 RUBBER RING FOR 80	142	2129005-101-B BEL HING COMPLETE	171	2129405-344 FEED REGULATOR ARM
16C	2110901-222-A SPRING FOR 16B	82	2129003-234 BUSHING FOR 80	143	2129005-101-B BEL HING COMPLETE	172	2129405-344 FEED REGULATOR ARM
16D	9060200-007 STOP RING FOR 16B, 76B, ETC	83	2129003-234 BUSHING FOR 80	144	2129005-101-B BEL HING COMPLETE	173	2129405-344 FEED REGULATOR ARM
16E	9561003-223 SLEEVE FOR 16B	84	9501201-276 SET SCREW FOR 82	145	2129005-101-B BEL HING COMPLETE	174	2129405-344 FEED REGULATOR ARM
17	2129401-215-B GASKET FOR 16	85	9501201-276 SET SCREW FOR 82	146	2129005-101-B BEL HING COMPLETE	175	2129405-344 FEED REGULATOR ARM
18	2129401-181-A GASKET FOR 18	86	2129003-315 PRESSER BAR LIFTER CRANK	147	2129005-101-B BEL HING COMPLETE	176	2129405-344 FEED REGULATOR ARM
19	2129401-220-A FACE COVER PLATE COMPLETE	87	9501201-276 SET SCREW FOR 82	148	2129005-101-B BEL HING COMPLETE	177	2129405-344 FEED REGULATOR ARM
20A	2129401-224-A CLAMP FOR 20 & 45	88	9501201-276 SET SCREW FOR 82	149	2129005-101-B BEL HING COMPLETE	178	2129405-344 FEED REGULATOR ARM
21	9561003-292-A SET SCREW FOR 20	89	2129003-411-A SPRING FOR 88	150	2129005-101-B BEL HING COMPLETE	179	2129405-344 FEED REGULATOR ARM
22	2129001-224 PLUG FOR SCREW HOLE	90	2110203-412 ADJUST PLATE FOR TENSION	151	2110204-321 OIL PAN COMPLETE	180	2129405-344 FEED REGULATOR ARM
24	2129404-119 SET SCREW FOR 68 & 222	91	2110203-412 ADJUST PLATE FOR TENSION	152	2110204-321 OIL PAN COMPLETE	181	2129405-344 FEED REGULATOR ARM
26	9540906-124 TENSION COMPLETE	92	9509000-215-A SET SCREW FOR 91 & 173	153	2110204-321 OIL PAN COMPLETE	182	2129405-344 FEED REGULATOR ARM
27A	2110292-354 CHECK SPRING	93	2129003-222 RIGHT	154	2110204-321 OIL PAN COMPLETE	183	2129405-344 FEED REGULATOR ARM
27B	2110292-355-A TENSION SPRING	94	9015000-048 HINGE SCREW FOR 93	155	2110204-321 OIL PAN COMPLETE	184	2129405-344 FEED REGULATOR ARM
27C	2110292-359 TENSION SPRING	95	9015000-048 HINGE SCREW FOR 93	156	2110204-321 OIL PAN COMPLETE	185	2129405-344 FEED REGULATOR ARM
27D	2110292-366 BATCHET FOR 27B	96	9015000-048 HINGE SCREW FOR 93	157	2110204-321 OIL PAN COMPLETE	186	2129405-344 FEED REGULATOR ARM
27E	2110292-358 SET SCREW FOR TENSION STUD	97	2129003-321 KNEE LIFTER PULL ROD	158	2110204-321 OIL PAN COMPLETE	187	2129405-344 FEED REGULATOR ARM
29	9501506-276 SET SCREW FOR 27	98	9410125-100 NUT FOR 97	159	2110204-321 OIL PAN COMPLETE	188	2129405-344 FEED REGULATOR ARM
29	9501506-276 SET SCREW FOR 27	99	2110203-412 ADJUST PLATE FOR TENSION	160	2110204-321 OIL PAN COMPLETE	189	2129405-344 FEED REGULATOR ARM
31	2110222-111-C NEEDLE BAR ONLY	99A	2110203-412 ADJUST PLATE FOR TENSION	161	2110204-321 OIL PAN COMPLETE	190	2129405-344 FEED REGULATOR ARM
31	2110222-111-C NEEDLE BAR ONLY	99B	2110203-412 ADJUST PLATE FOR TENSION	162	2110204-321 OIL PAN COMPLETE	191	2129405-344 FEED REGULATOR ARM
32	9540906-259 SET SCREW FOR 30	99C	2110203-412 ADJUST PLATE FOR TENSION	163	2110204-321 OIL PAN COMPLETE	192	2129405-344 FEED REGULATOR ARM
33	2110402-194 NEEDLE	99D	2110203-412 ADJUST PLATE FOR TENSION	164	2110204-321 OIL PAN COMPLETE	193	2129405-344 FEED REGULATOR ARM
34	2129403-111 NEEDLE PLATE	99E	2110203-412 ADJUST PLATE FOR TENSION	165	2110204-321 OIL PAN COMPLETE	194	2129405-344 FEED REGULATOR ARM
35	2110213-120 SLIDE PLATE COMPLETE	99F	9060200-048 JOINT FOR 97	166	2110204-321 OIL PAN COMPLETE	195	2129405-344 FEED REGULATOR ARM
35A	1110301-522 SPRING FOR 35	99G	9060200-048 JOINT FOR 97	167	2110204-321 OIL PAN COMPLETE	196	2129405-344 FEED REGULATOR ARM
35B	9540901-119 SET SCREW FOR 35A	99H	9060200-048 JOINT FOR 97	168	2110204-321 OIL PAN COMPLETE	197	2129405-344 FEED REGULATOR ARM
37	2129402-511 NEEDLE BAR ARM	99I	9060200-048 JOINT FOR 97	169	2110204-321 OIL PAN COMPLETE	198	2129405-344 FEED REGULATOR ARM
37	2129402-511 NEEDLE BAR ARM	99J	9060200-048 JOINT FOR 97	170	2110204-321 OIL PAN COMPLETE	199	2129405-344 FEED REGULATOR ARM
38	9501506-006 SET SCREW FOR 42, 173, ETC	99K	9060200-048 JOINT FOR 97	171	2110204-321 OIL PAN COMPLETE	200	2129405-344 FEED REGULATOR ARM
38	9501506-006 SET SCREW FOR 42, 173, ETC	99L	9060200-048 JOINT FOR 97	172	2110204-321 OIL PAN COMPLETE	201	2129405-344 FEED REGULATOR ARM
40	2129405-432 NEEDLE FEED HOCK LINK	99M	9060200-048 JOINT FOR 97	173	2110204-321 OIL PAN COMPLETE	202	2129405-344 FEED REGULATOR ARM
41	2129405-432 NEEDLE FEED HOCK LINK	99N	9060200-048 JOINT FOR 97	174	2110204-321 OIL PAN COMPLETE	203	2129405-344 FEED REGULATOR ARM
42	2129405-432 NEEDLE FEED HOCK LINK	99O	9060200-048 JOINT FOR 97	175	2110204-321 OIL PAN COMPLETE	204	2129405-344 FEED REGULATOR ARM
43	2129405-431 NEEDLE FEED HOCK ARM	99P	9060200-048 JOINT FOR 97	176	2110204-321 OIL PAN COMPLETE	205	2129405-344 FEED REGULATOR ARM
45	9841005-456 NEEDLE FEED HOCK ARM	99Q	9060200-048 JOINT FOR 97	177	2110204-321 OIL PAN COMPLETE	206	2129405-344 FEED REGULATOR ARM
46	2129402-513 HINGE SHAFT FOR 43, 179, ETC	99R	9060200-048 JOINT FOR 97	178	2110204-321 OIL PAN COMPLETE	207	2129405-344 FEED REGULATOR ARM
47	1229402-321 OIL STOP RUBBER FOR 37	99S	9060200-048 JOINT FOR 97	179	2110204-321 OIL PAN COMPLETE	208	2129405-344 FEED REGULATOR ARM
48	9060100-013 OIL SEAL FOR 47	99T	9060200-048 JOINT FOR 97	180	2110204-321 OIL PAN COMPLETE	209	2129405-344 FEED REGULATOR ARM
49	2110201-254 PLUG FOR SCREW HOLE	99U	9060200-048 JOINT FOR 97	181	2110204-321 OIL PAN COMPLETE	210	2129405-344 FEED REGULATOR ARM
49	2110201-254 PLUG FOR SCREW HOLE	99V	9060200-048 JOINT FOR 97	182	2110204-321 OIL PAN COMPLETE	211	2129405-344 FEED REGULATOR ARM
50A	2129404-340 COLLAR COMPLETE FOR 47	99W	9060200-048 JOINT FOR 97	183	2110204-321 OIL PAN COMPLETE	212	2129405-344 FEED REGULATOR ARM
50A	2129404-340 COLLAR COMPLETE FOR 47	99X	9060200-048 JOINT FOR 97	184	2110204-321 OIL PAN COMPLETE	213	2129405-344 FEED REGULATOR ARM
50A	2129404-340 COLLAR COMPLETE FOR 47	99Y	9060200-048 JOINT FOR 97	185	2110204-321 OIL PAN COMPLETE	214	2129405-344 FEED REGULATOR ARM
51	2129402-512 GUIDE FOR 36	99Z	9060200-048 JOINT FOR 97	186	2110204-321 OIL PAN COMPLETE	215	2129405-344 FEED REGULATOR ARM
52	9531102-219 SET SCREW FOR 51	100	2110203-412 ADJUST PLATE FOR TENSION	187	2110204-321 OIL PAN COMPLETE	216	2129405-344 FEED REGULATOR ARM
53	2129405-393 OIL WICK RETAINER FOR 51	101	2110203-412 ADJUST PLATE FOR TENSION	188	2110204-321 OIL PAN COMPLETE	217	2129405-344 FEED REGULATOR ARM
54	9531102-219 SET SCREW FOR 51	102	2110203-412 ADJUST PLATE FOR TENSION	189	2110204-321 OIL PAN COMPLETE	218	2129405-344 FEED REGULATOR ARM
55	2110232-130 TAKE UP LEVER CRANK COMPLETE	103	2110203-412 ADJUST PLATE FOR TENSION	190	2110204-321 OIL PAN COMPLETE	219	2129405-344 FEED REGULATOR ARM
55A	9013400-013 SET SCREW FOR 55	104	2110203-412 ADJUST PLATE FOR TENSION	191	2110204-321 OIL PAN COMPLETE	220	2129405-344 FEED REGULATOR ARM
55B	9501801-276 SET SCREW FOR 55	105	2110203-412 ADJUST PLATE FOR TENSION	192	2110204-321 OIL PAN COMPLETE	221	2129405-344 FEED REGULATOR ARM
55C	9501801-276 SET SCREW FOR 55	106	2110203-412 ADJUST PLATE FOR TENSION	193	2110204-321 OIL PAN COMPLETE	222	2129405-344 FEED REGULATOR ARM
56	2129402-02-C TAKE UP LEVER COMPLETE	107	2110203-412 ADJUST PLATE FOR TENSION	194	2110204-321 OIL PAN COMPLETE	223	2129405-344 FEED REGULATOR ARM
57	2129402-150 HINGE STUD FOR 56	108	2110203-412 ADJUST PLATE FOR TENSION	195	2110204-321 OIL PAN COMPLETE	224	2129405-344 FEED REGULATOR ARM
58A	9509001-215-A NEEDLE BAR GUIDE BRACKET	109	2110203-412 ADJUST PLATE FOR TENSION	196	2110204-321 OIL PAN COMPLETE		
59	2129003-215-A NEEDLE BAR GUIDE BRACKET	110	2110203-412 ADJUST PLATE FOR TENSION	197	2110204-321 OIL PAN COMPLETE		
60	9501506-276-A SET SCREW FOR 58, 174, ETC	111	2110203-412 ADJUST PLATE FOR TENSION	198	2110204-321 OIL PAN COMPLETE		
61	2110203-271-A PRESSURE REGULATOR SCREW	112	2110203-412 ADJUST PLATE FOR TENSION	199	2110204-321 OIL PAN COMPLETE		
62	2110203-272-A PRESSURE REGULATOR ROD	113	2110203-412 ADJUST PLATE FOR TENSION	200	2110204-321 OIL PAN COMPLETE		
63	2129403-213 PRESSER SPRING, INNER	114	2110203-412 ADJUST PLATE FOR TENSION	201	2110204-321 OIL PAN COMPLETE		
		115	2110203-412 ADJUST PLATE FOR TENSION	202	2110204-321 OIL PAN COMPLETE		
		116	2110203-412 ADJUST PLATE FOR TENSION	203	2110204-321 OIL PAN COMPLETE		
		117	2110203-412 ADJUST PLATE FOR TENSION	204	2110204-321 OIL PAN COMPLETE		
		118	2110203-412 ADJUST PLATE FOR TENSION	205	2110204-321 OIL PAN COMPLETE		
		119	2110203-412 ADJUST PLATE FOR TENSION	206	2110204-321 OIL PAN COMPLETE		
		120	2110203-412 ADJUST PLATE FOR TENSION	207	2110204-321 OIL PAN COMPLETE		
		121	2110203-412 ADJUST PLATE FOR TENSION	208	2110204-321 OIL PAN COMPLETE		
		122	2110203-412 ADJUST PLATE FOR TENSION	209	2110204-321 OIL PAN COMPLETE		
		123	2110203-412 ADJUST PLATE FOR TENSION	210	2110204-321 OIL PAN COMPLETE		
		124	2110203-412 ADJUST PLATE FOR TENSION	211	2110204-321 OIL PAN COMPLETE		
		125	2110203-412 ADJUST PLATE FOR TENSION	212	2110204-321 OIL PAN COMPLETE		
		126	2110203-412 ADJUST PLATE FOR TENSION	213	2110204-321 OIL PAN COMPLETE		
		127	2110203-412 ADJUST PLATE FOR TENSION	214	2110204-321 OIL PAN COMPLETE		
		128	2110203-412 ADJUST PLATE FOR TENSION	215	2110204-321 OIL PAN COMPLETE		
		129	2110203-412 ADJUST PLATE FOR TENSION	216	2110204-321 OIL PAN COMPLETE		
		130	2110203-412 ADJUST PLATE FOR TENSION	217	2110204-321 OIL PAN COMPLETE		
		131	2110203-412 ADJUST PLATE FOR TENSION	218	2110204-321 OIL PAN COMPLETE		
		132	2110203-412 ADJUST PLATE FOR TENSION	219	2110204-321 OIL PAN COMPLETE		
		133	2110203-412 ADJUST PLATE FOR TENSION	220	2110204-321 OIL PAN COMPLETE		
		134	2110203-412 ADJUST PLATE FOR TENSION	221	2110204-321 OIL PAN COMPLETE		
		135	2110203-412 ADJUST PLATE FOR TENSION	222	2110204-321 OIL PAN COMPLETE		
		136	2110203-412 ADJUST PLATE FOR TENSION	223	2110204-321 OIL PAN COMPLETE		
		137	2110203-412 ADJUST PLATE FOR TENSION				